



Oggetto
PROGETTAZIONE ESECUTIVA DELLE OPERE MECCANICHE ED IMPIANTISTICHE PER I NUOVI ASCENSORI DELLA TORRE DEL PASSETTO
CUP: E37E16000010004 - CIG: 6849510A74

SERPILLI
engineering
Via Salaria, 54 - 07100 Macerata
Sede Operativa: Ancona, Via Garibaldi, 45h
Telefono e Fax: **+39 071 9945538**
Mail to: info@serpilli.com Web: www.serpilli.com

Committente
COMUNE DI ANCONA

Progettazione
Ing. Gianluca SERPILLI
Arch. Claudia SERPILLI



Firma e visto

Titolo
PARTICOLARI COSTRUTTIVI NUOVI ASCENSORI

Foglio

102

Commessa

16108

File

particolari.dwg

Scala

1 : 25

Programma	Provvisoria	Definitiva	Esecutivo	As-Built
001	OTT2016	Prima emissione	CS	GS
			GS	GS

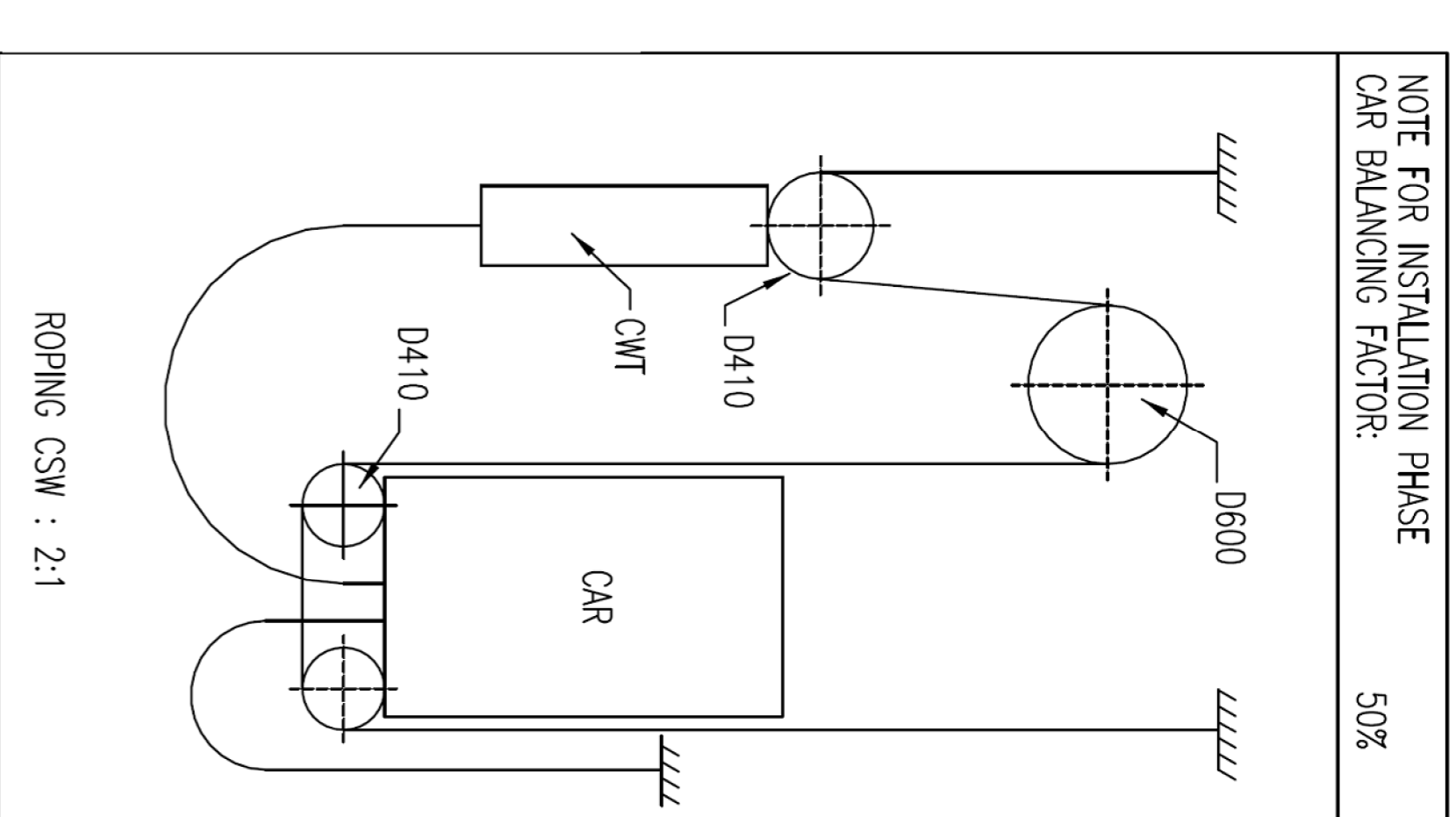
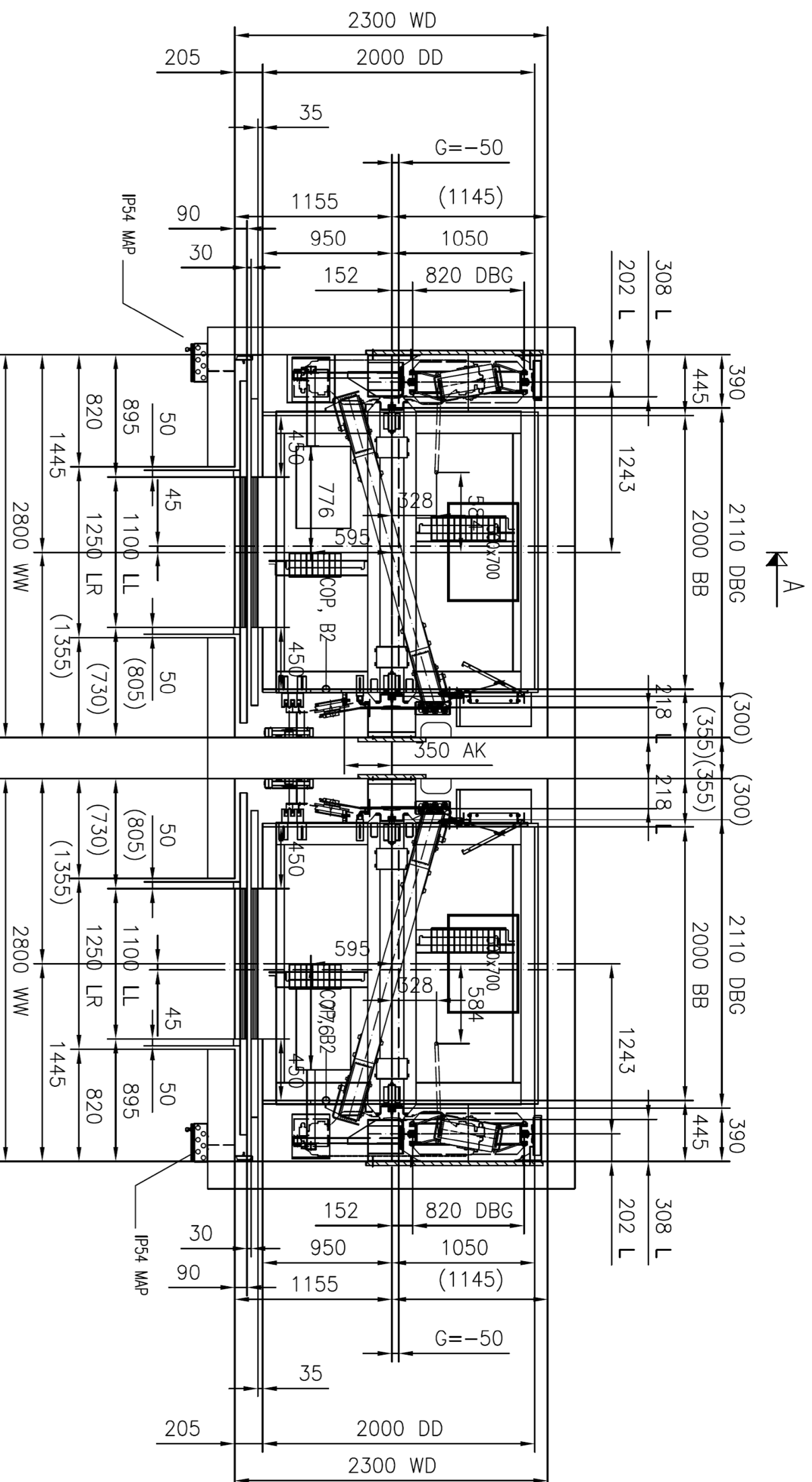

Balancing weights	
1	1200 kg
2	1300 kg

MAIN TECHNICAL SPECIFICATION FOR ELEVATOR(S):	
Safety regulations	EN81-20/50; EN81-70; EN81-73
KONE product type	PW26/20-19
Load type	Passenger
Rated load	2000 kg
Number of persons	26
Rated speed	2.0 m/s
No. of stops/landing doors	3/3
Trovel	32760 mm
Group size	2

ELECTRICAL REQUIREMENTS	
Main supply voltage	: 3x400Vac -15%/+10%
Frequency	: 50 Hz ±1 Hz
Riser fuses	: 3x40 A
Riser fuses for separate lighting	: 16 A
Nominal line current, I _n	: 40.2 A
Max. RMS acceleration line current, I _a	: 64.5 A
Main fuses	: 3x35 A
Lighting fuses (shaft + car)	: 15 A + 6 A
Thermal losses in machine room	: 2.41 kW
Motor output power at nominal load, P	: 21.1 kW
Motor RPM at full speed	: 128 rpm
Maximum start/hour, s/h	: 240/ED 60%

COMPONENTS & NOTES:

- WX20 machinery
- KOT 4098kg
- ISCS25 car sling
- FGWTO4 CWT
- CWT filler bit materials: steel 2918 kg
- T125/B / 182/B
- 7x010 ropes
- GAP2:EU-type-examined model lift
- Pit access Door needed and supply by local
- Temporary Lifting hooks needed since SH>4200mm
- Machine raised by 2000mm from its standard position
- IP54 protection needed in shaft, pit and car top box
- IP54 shaft light placed vertically, due to shaft constrained
- IP54 shaft light placed vertically, due to shaft constrained
- Local dividing beam width 3000mm, followed
- Dividing screen is required from pit floor to 2.5m of first landing by local
- Special wall fixing needed for Oscillators
- 1XOL35 compensation chain needed
- Compensation chain guides needed for car and cwt side
- IP54 wall WAP followed

